

Mt Auburn Hospital Outpatient PT & OT Services

625 Mt Auburn St 1st Floor
Cambridge MA 02138

Phone: 617-499-5011
New Fax: 617-575-8611

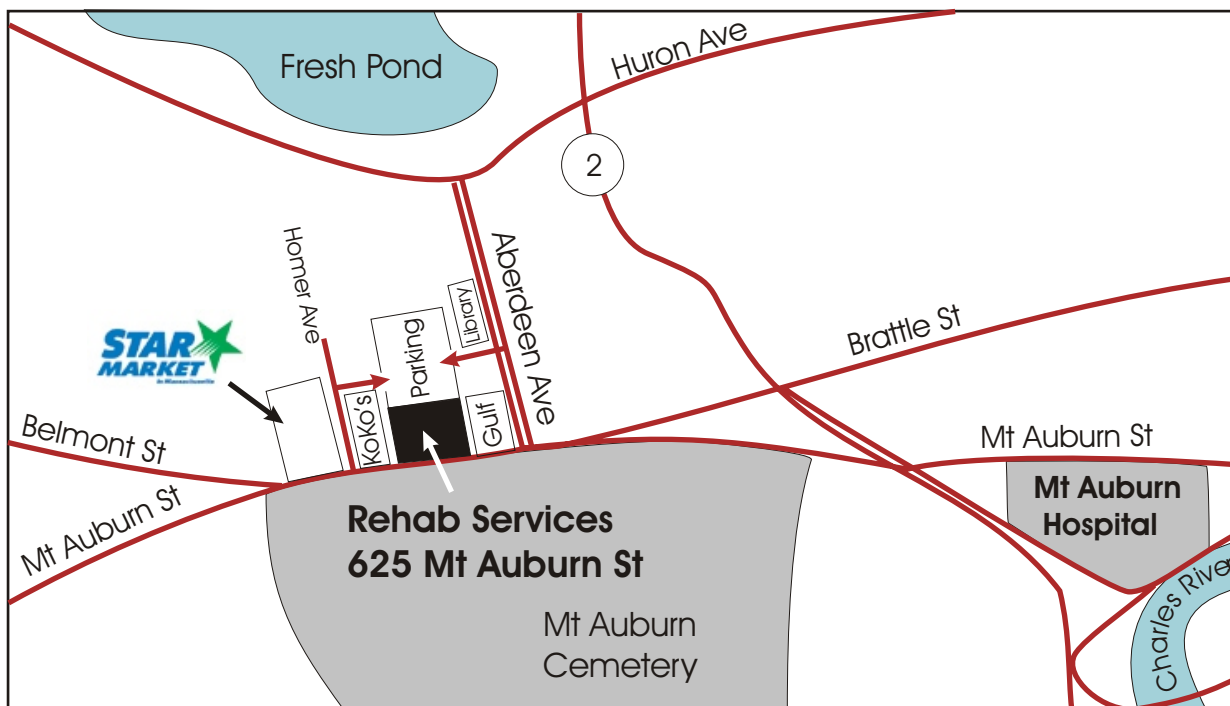

Free patient parking at the rear of the building-
Please use "MAH Patient" parking only.
Entrance from Homer Ave and Aberdeen Ave next to the Library.
Entrance to building from parking lot at the rear and
from Mt Auburn St at the front.
Bus 71 & 73 in front of the Star Market.
Bus 72 at Aberdeen Ave.

Mt Auburn Hospital Outpatient PT & OT Services

Patient Parking

625 Mt Auburn St

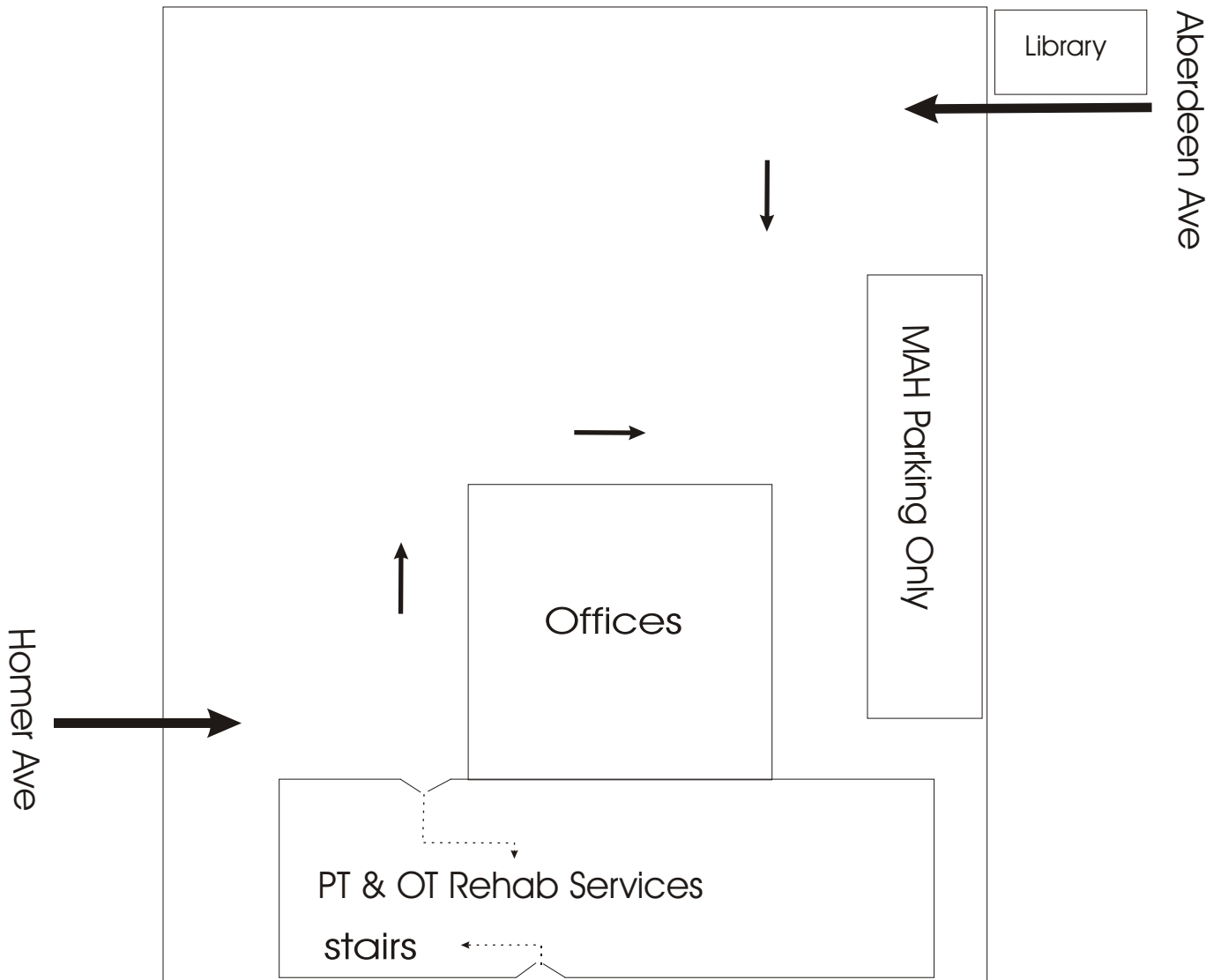

625 Mt Auburn St